

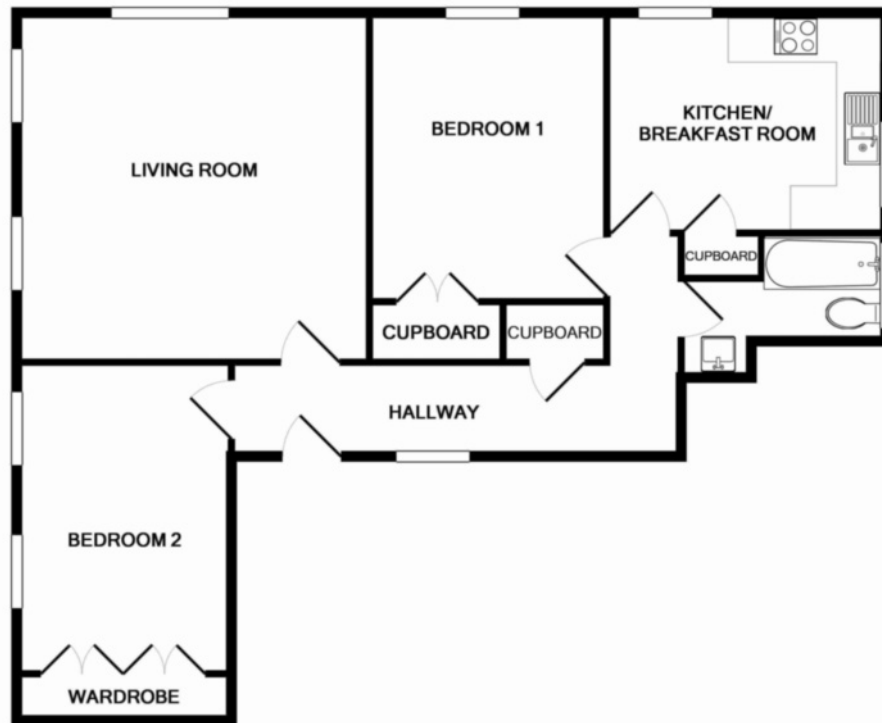

Chichester, PO19 1BA



Henry Adams Lettings is pleased to offer a third floor apartment within the City Walls which benefits from panoramic views over the top of Chichester and towards the Cathedral. Accommodation provides a contemporary dual aspect kitchen/breakfast room, dual aspect living/dining room, two double bedrooms with built in wardrobes and contemporary bathroom. gas fired central heating and double glazing.



TOTAL APPROX. FLOOR AREA 851 SQ.FT. (79.1 SQ.M.)

Whilst every attempt has been made to ensure the accuracy of the floor plan contained here, measurements of doors, windows, rooms and any other items are approximate and no responsibility is taken for any error, omission, or mis-statement. This plan is for illustrative purposes only and should be used as such by any prospective purchaser. The services, systems and appliances shown have not been tested and no guarantee as to their operability or efficiency can be given
Made with Metropix ©2014



* Please ask within for details or visit <http://www.henryadams.co.uk/lettings/process-and-fees>